



### Special offer

Inventory number: 15000

Double vertical turning lathe  
SCHUSTER VTM 350  
REXROTH INDRAMAT System 200 BTV 20  
2000



Price: 15 000.00 CHF

Machines in special offers are sold in AS-IS condition,  
<br>without any functional guarantee or mechanical/technical inspection from our side.  
<br>

### Technical data

Max. turning diameter	200 mm
Turret number of tools	2 x 12
Max. workpiece height	350 mm
Spindle speeds:	
stepless	
up to	8000 rpm
Feeds:	
stepless	
up to	5000 mm/min
Voltage 50 Hz 3x	400 Volt
Motor power	20 kW
Machine's weight about	6000 kg
Floor space required:	
Length	3000 mm

Width 1700 mm

Height 3350 mm

Various accessories:

Full splash cabin





INVENTAR-NR:  
15013

Revroth  
Indramat

SYSTEM200

VTM350

Control panel section 1:

- Vertical buttons: L1-L8 (left), R1-R8 (right)
- Function keys: F2-F9, OP2-OP9
- Color-coded buttons: HAND (green), AUTO LOKAL (orange), AUTO (pink), CLEAR (light blue), MDI (yellow), MDI START (green), START (green), STOP (red), Grund Stellung (green), STOP/QUIT (red), NC/RESET (light blue), ESC (yellow), OK (green)
- Navigation keys: 7-9, <, >, F1, F10, PROC, SFT, 4-6, NEXT, INFO, TAB, INS, DEL, SP, CTRL, ALT, arrow keys, ESC, OK

Control panel section 2:

- Alphanumeric keypad: X, Z, W, Y, R, C, V, U, T, S, D, F, G, H, J, K, L, M, N, O, P, Q, R, S, T, U, V, W, X, Y, Z, 0-9, ., /, \*, =, <, >, [, ], ^, \_
- Rotary dials: Three large rotary dials for parameter selection and adjustment.
- Buttons: A row of small buttons below the dials.

Control panel section 3:

- Emergency stop: Large red button with yellow ring labeled "NOT - AUS".
- Buttons: Multiple black buttons for various machine functions.
- Key: A key is inserted into a lock on the right side.











3 Hr. Drummer  
0041/32 373 4827

# Futureline 350\_VDI30\_12 fach

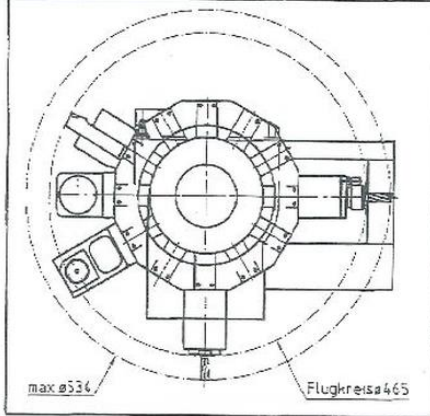
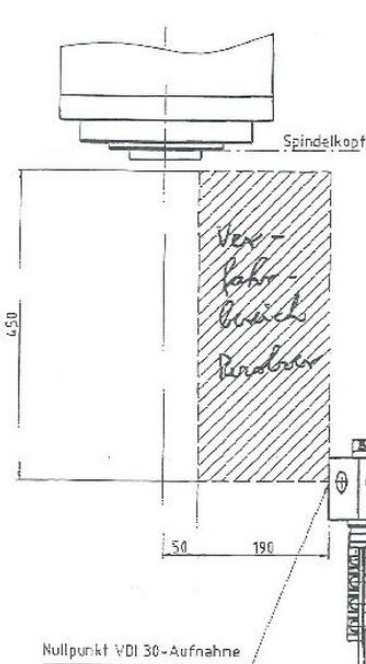

Revolverscheibe VDI 30-12 fach

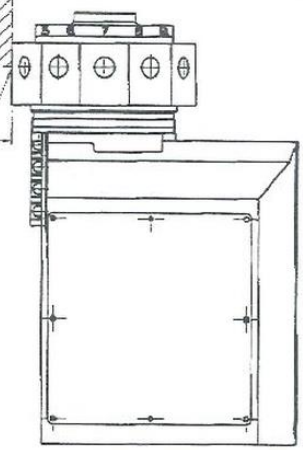
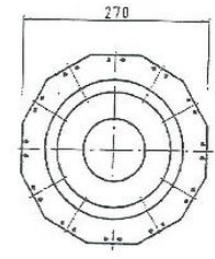

umlaufende Störkontur

